

1. 집기이설



2. 집기이설



변경전

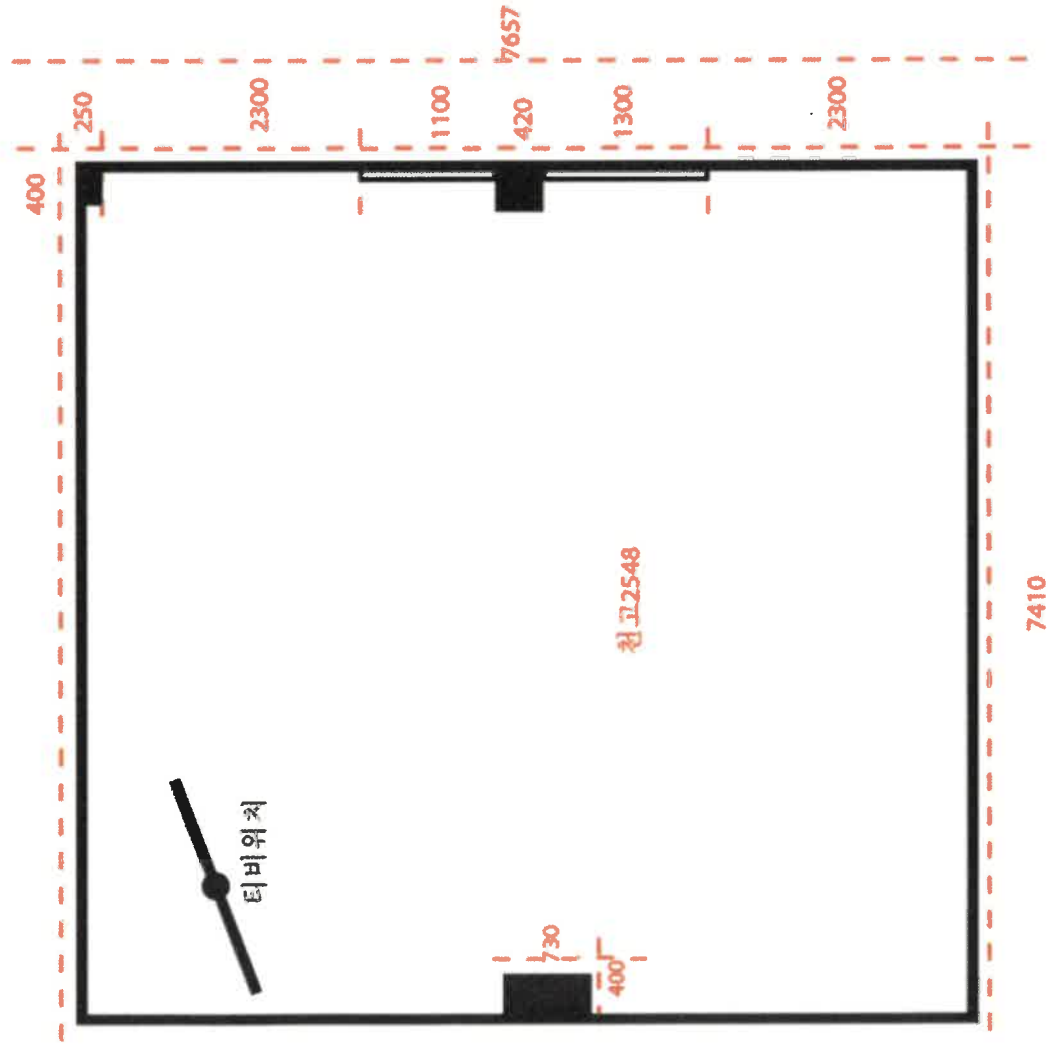

변경후

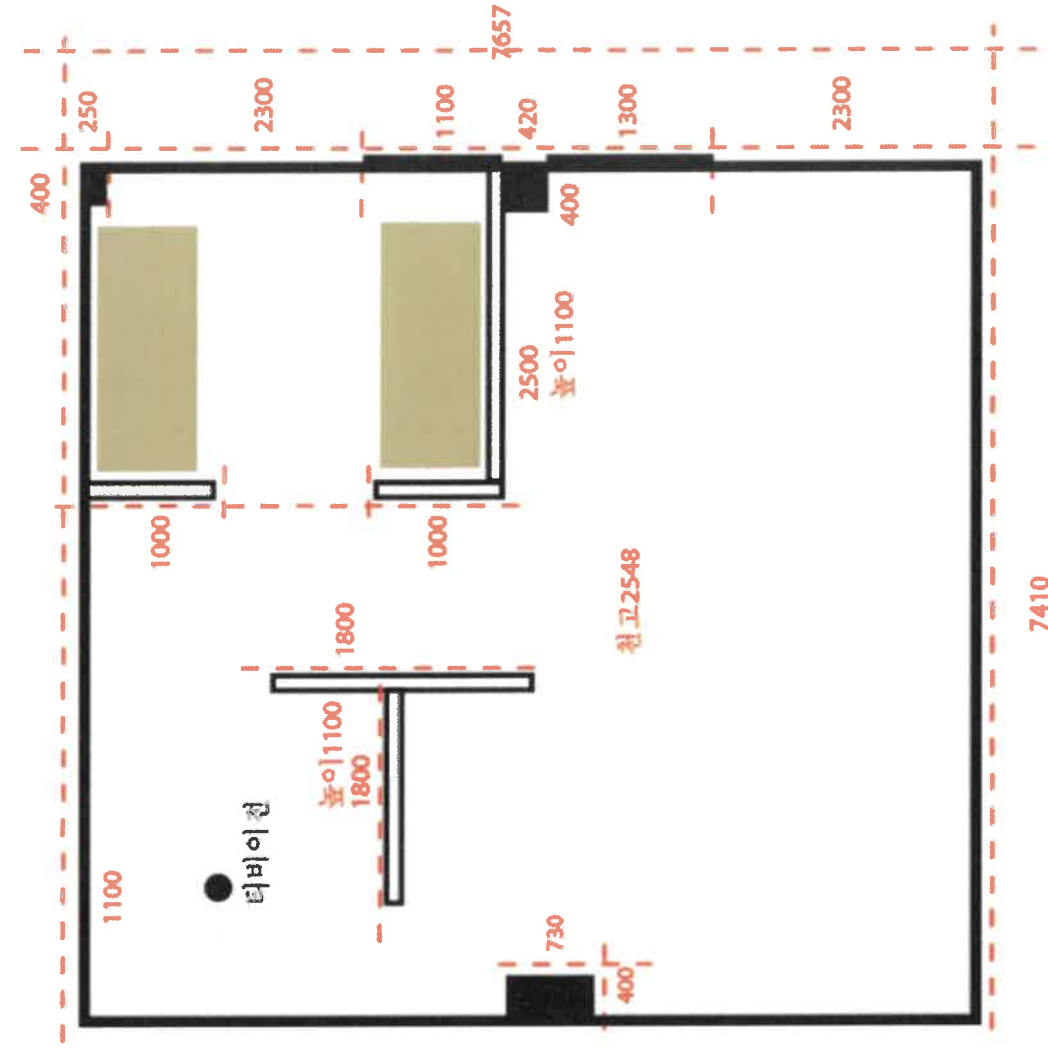

1.침대 칸막이 양면제작 템바루바 붙임

입면도

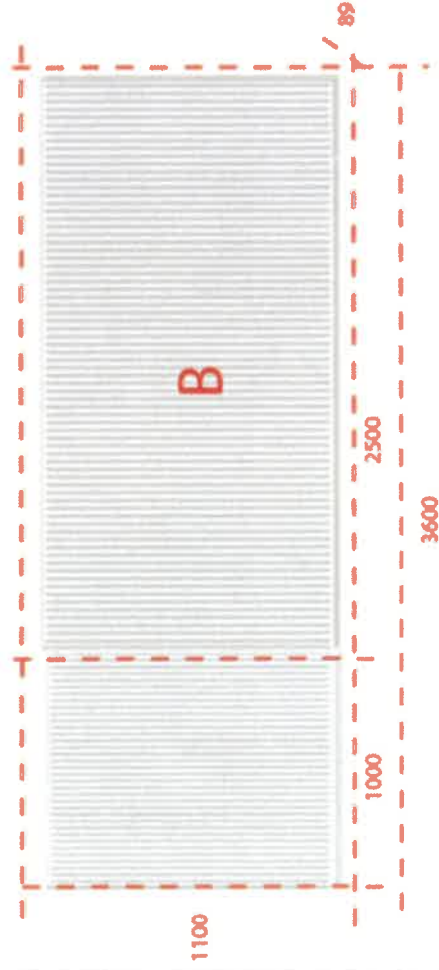
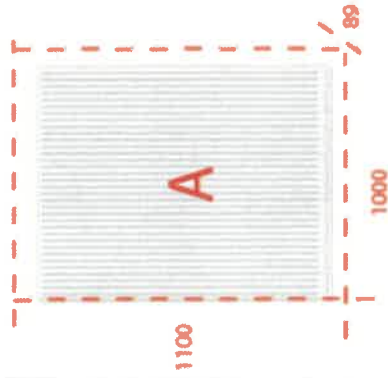

평면도

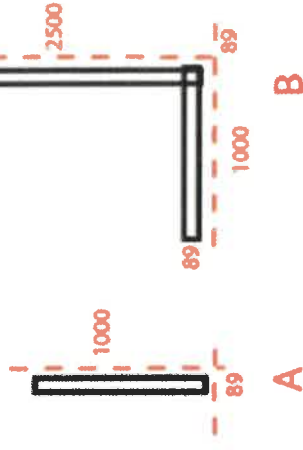

예시사진



1. 미송38*89 형틀 및 400간격
2. MDF9T 붙임, 방염 백색 템바루바 붙임 마감
3. 형틀 목재위 백색 오일마감
4. 상하부 몰딩

2.교사용 칸막이 양면제작 템바루바 붙임

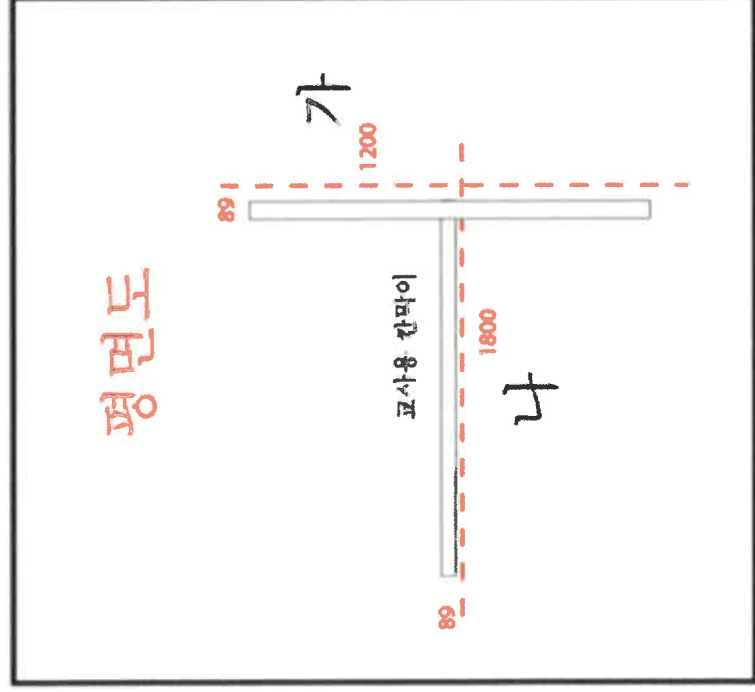
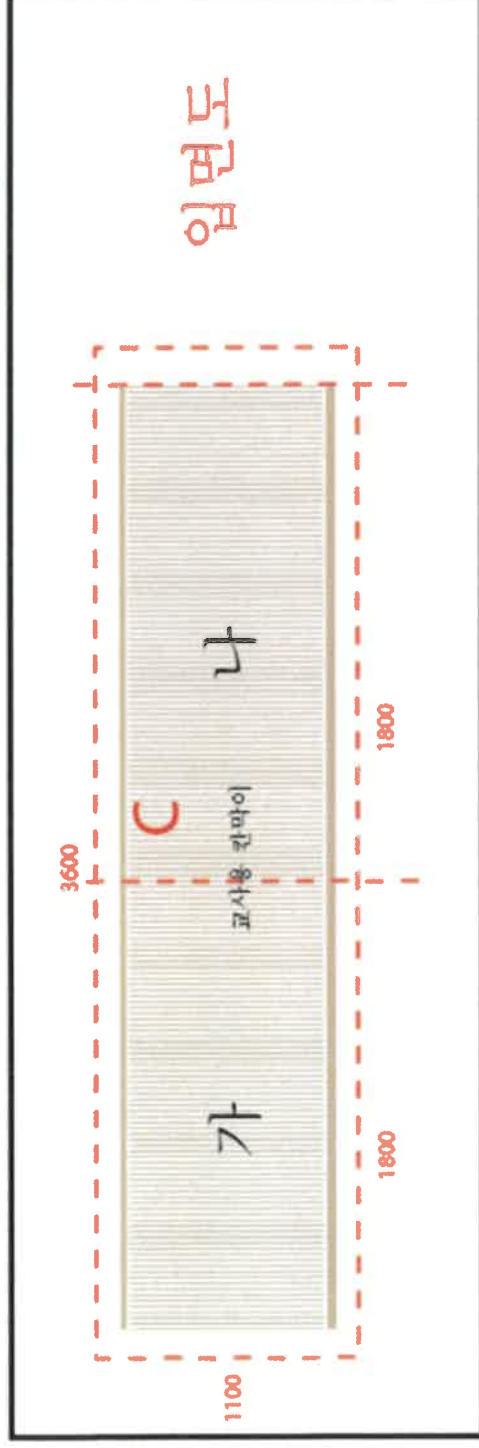

1. 미송38*89 형틀 및 400간격
2. MDF9T 붙임, 방염 백색 템바루바 붙임 마감
3. 형틀 목재위 투명오일마감.
4. 상하부 몰딩

3. 벽체 템바루바 붙임

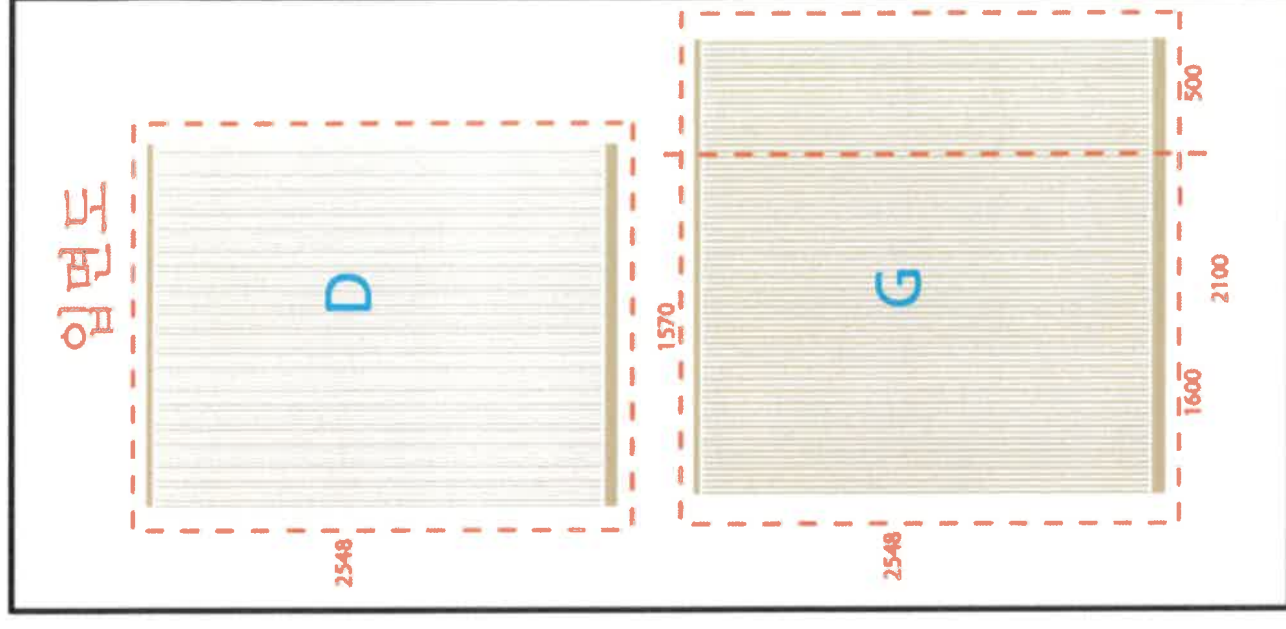
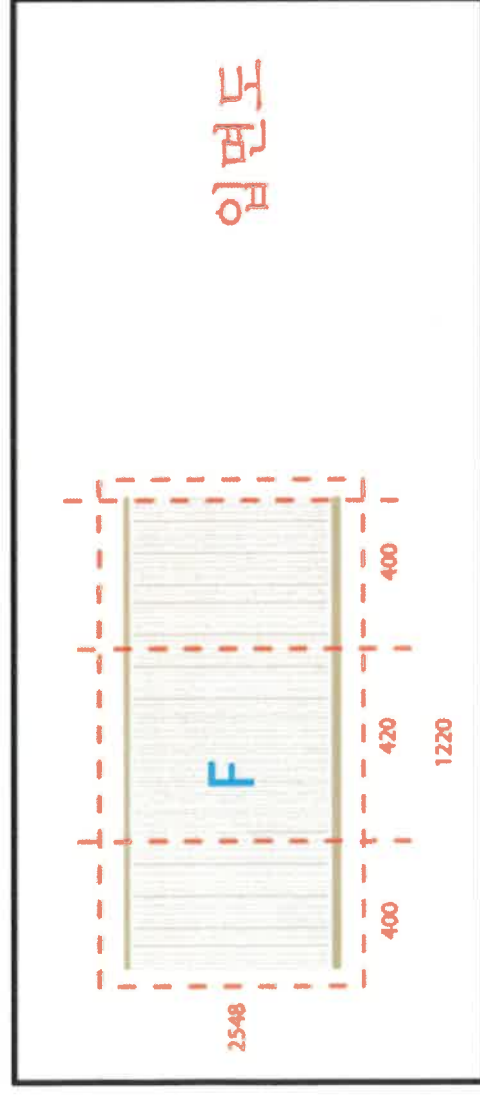
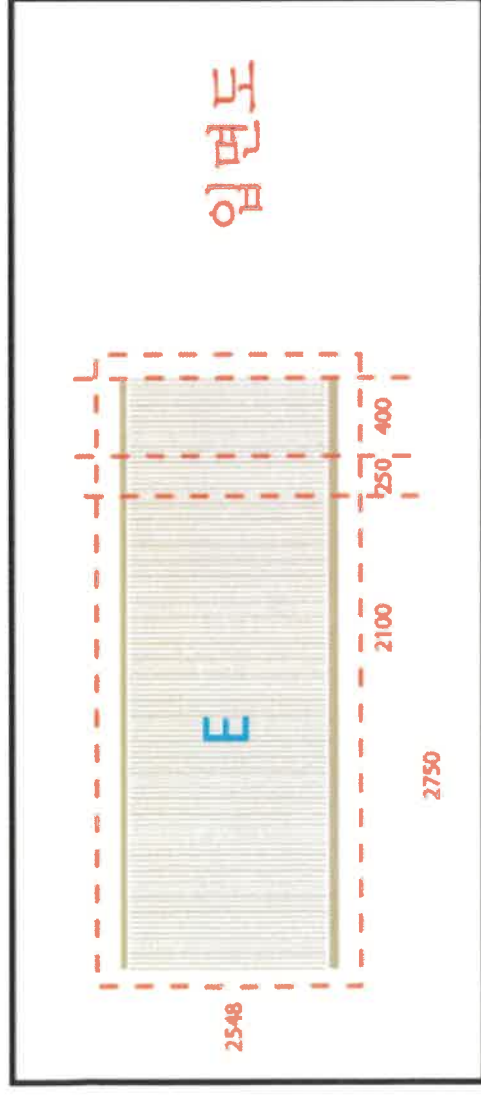

1. 미송 30*30형틀 및 400간격
2. MDF 9T 붙임, 방염 백색 템바루바 붙임 마감
3. 상하부 물딩

4.벽체 상부도장

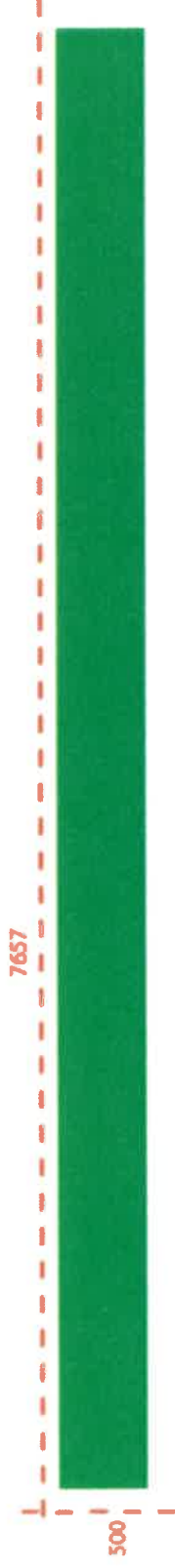

5.타일붙임

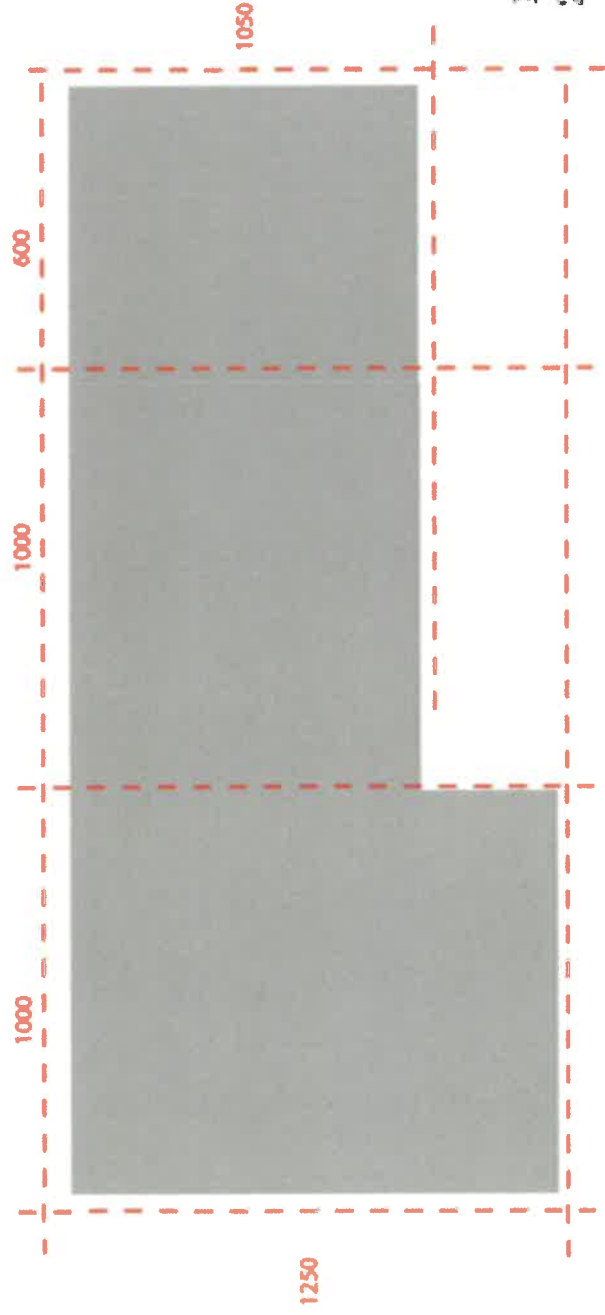

1. 친환경 내부 수성페인트 마감
2. 석고보드붙임 후 테라조 롱타일 마감

6.교실 강화마루 붙임

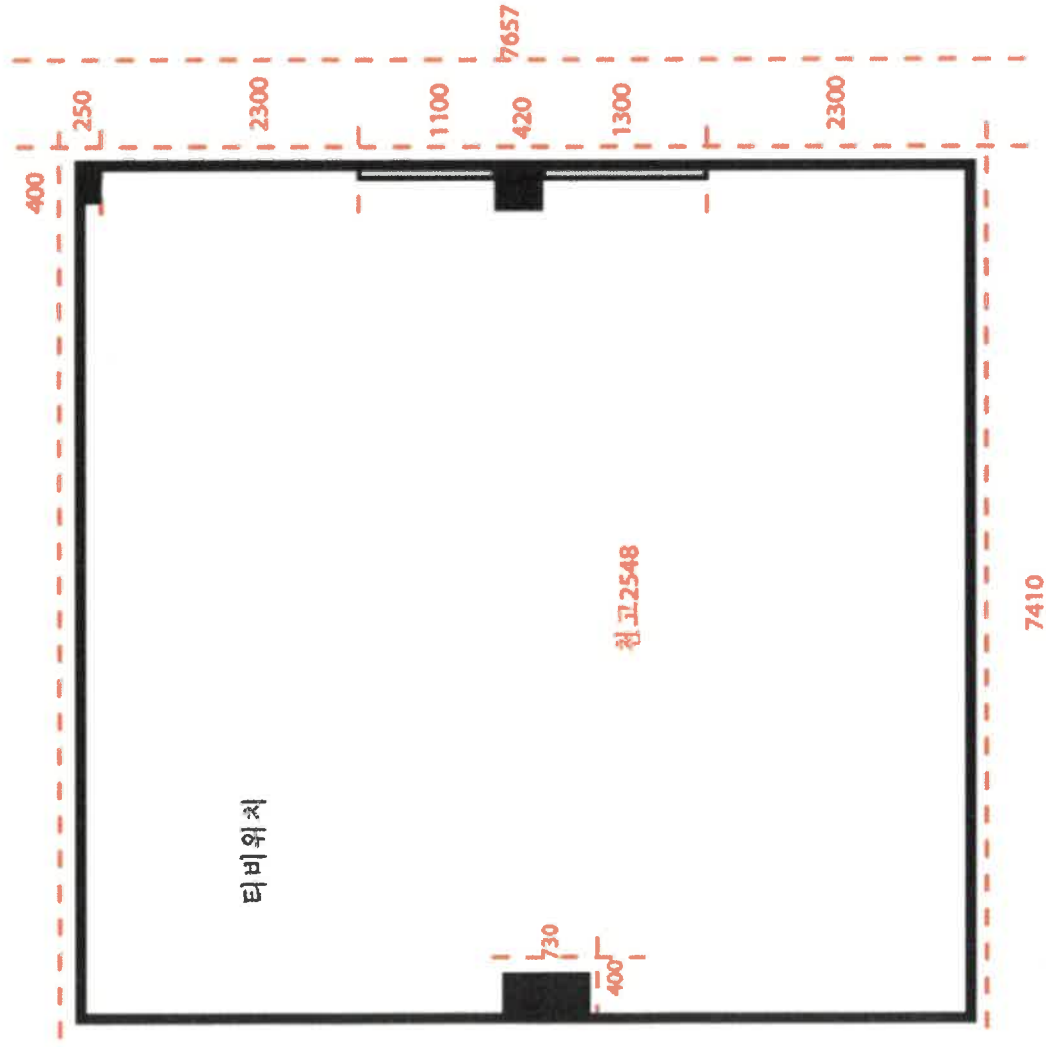

$$7.41 * 7.657 = 56.738 \text{ m}^2$$

7.수도 배관, 하수구 배관 이설 (교실1에서 교실3으로)

교실1

교실2

교실3

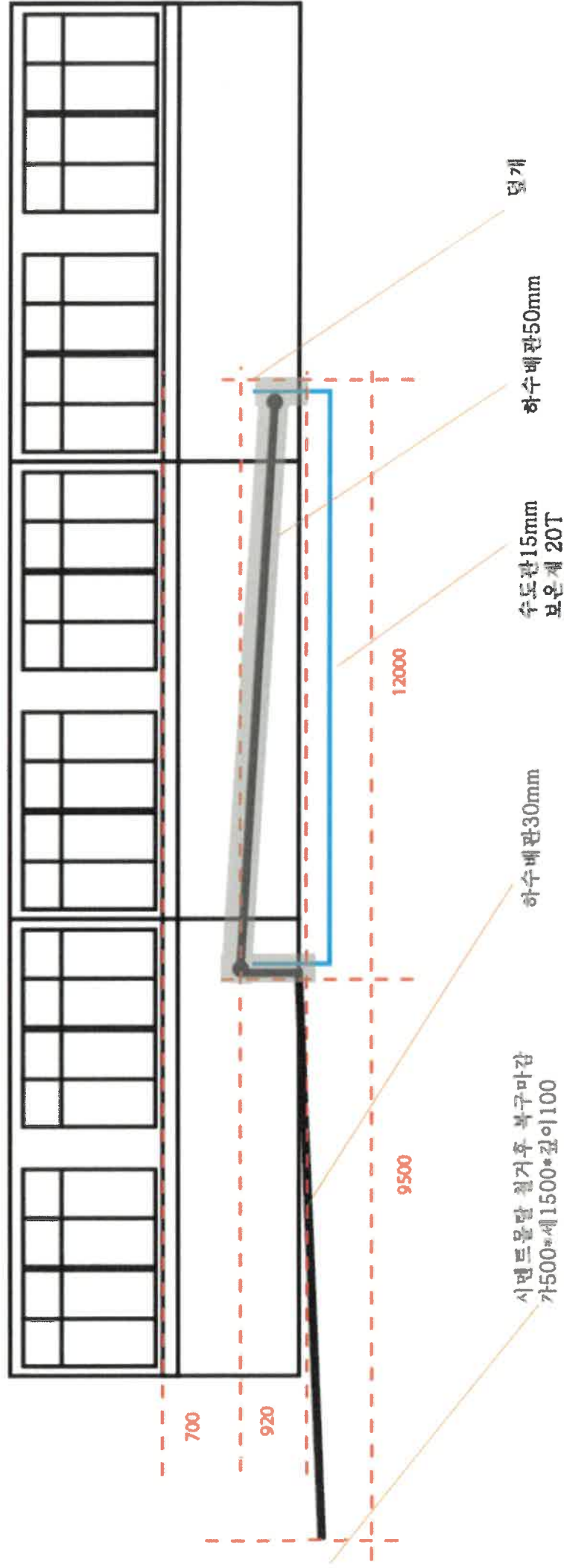

8. 상부장, 싱크대, 세족기, 전기온수기



싱크대 1000*600*770
세족기 1000*600*500
상부장 2000*300*800
전기 온수기 30L

파티션 상세도 B입면도 예시

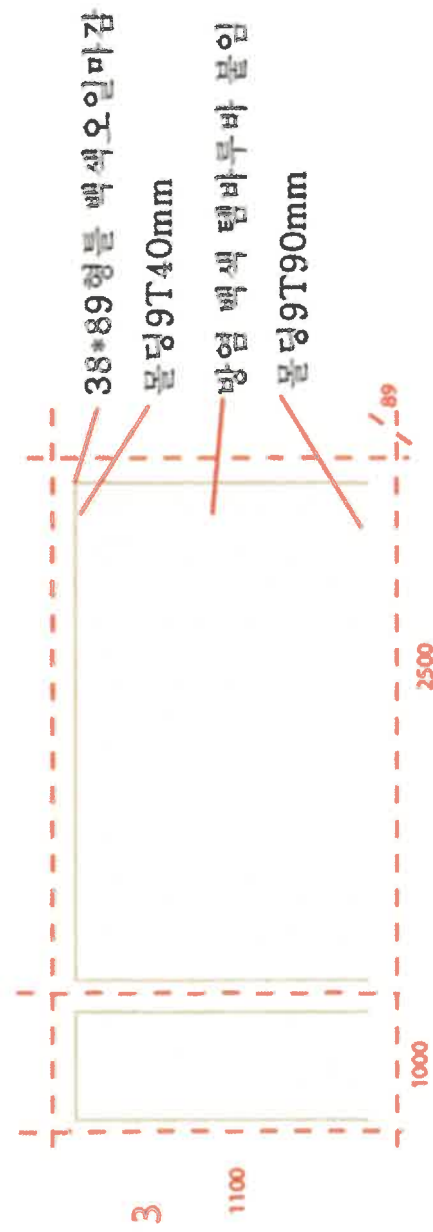
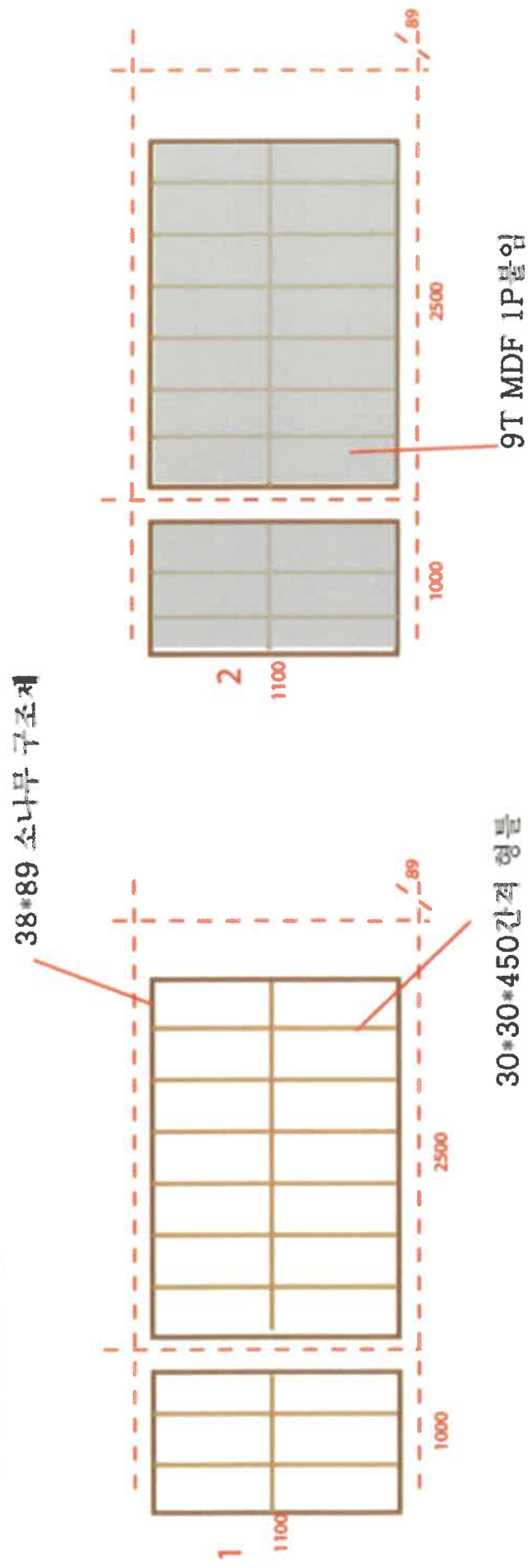

예시 사진



교실 템바루바



칸막이



교실 상부 도장

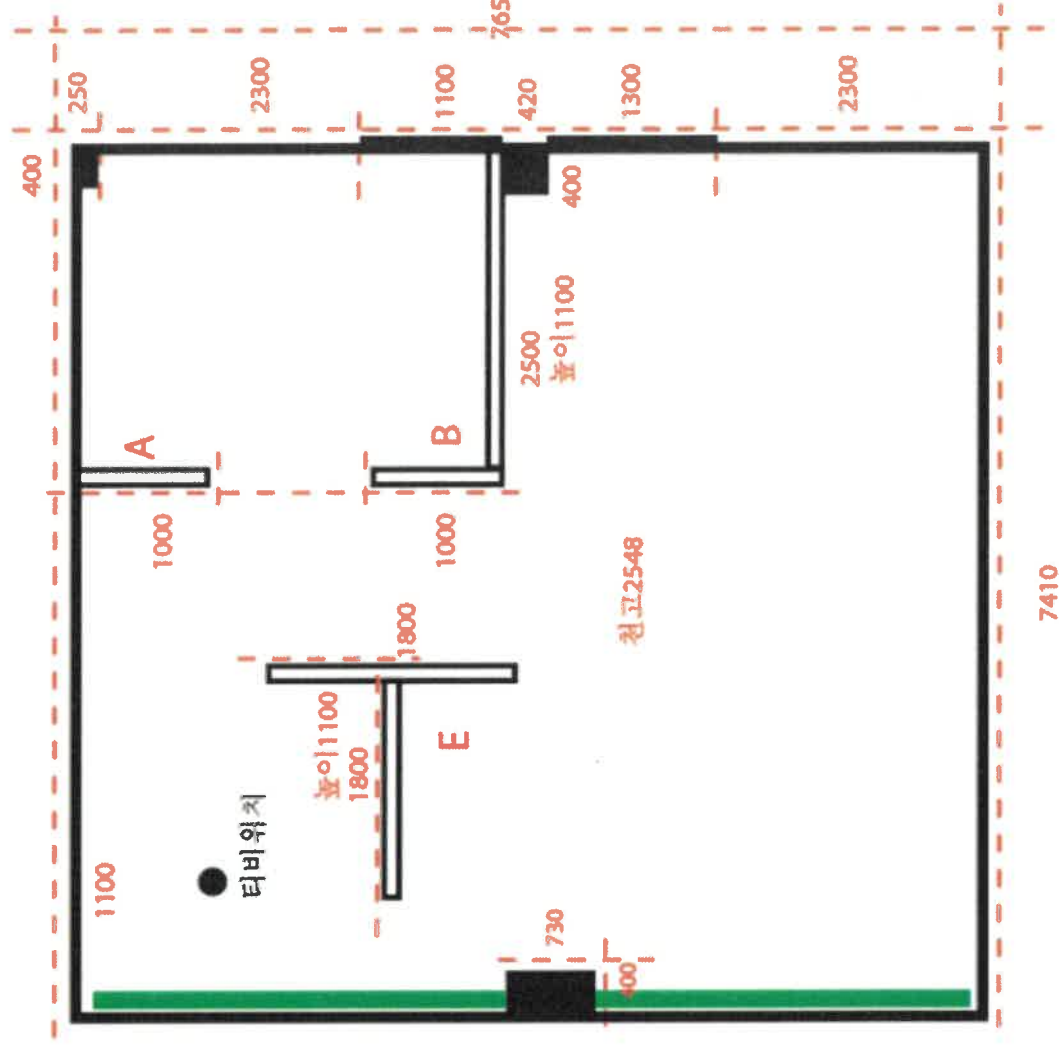
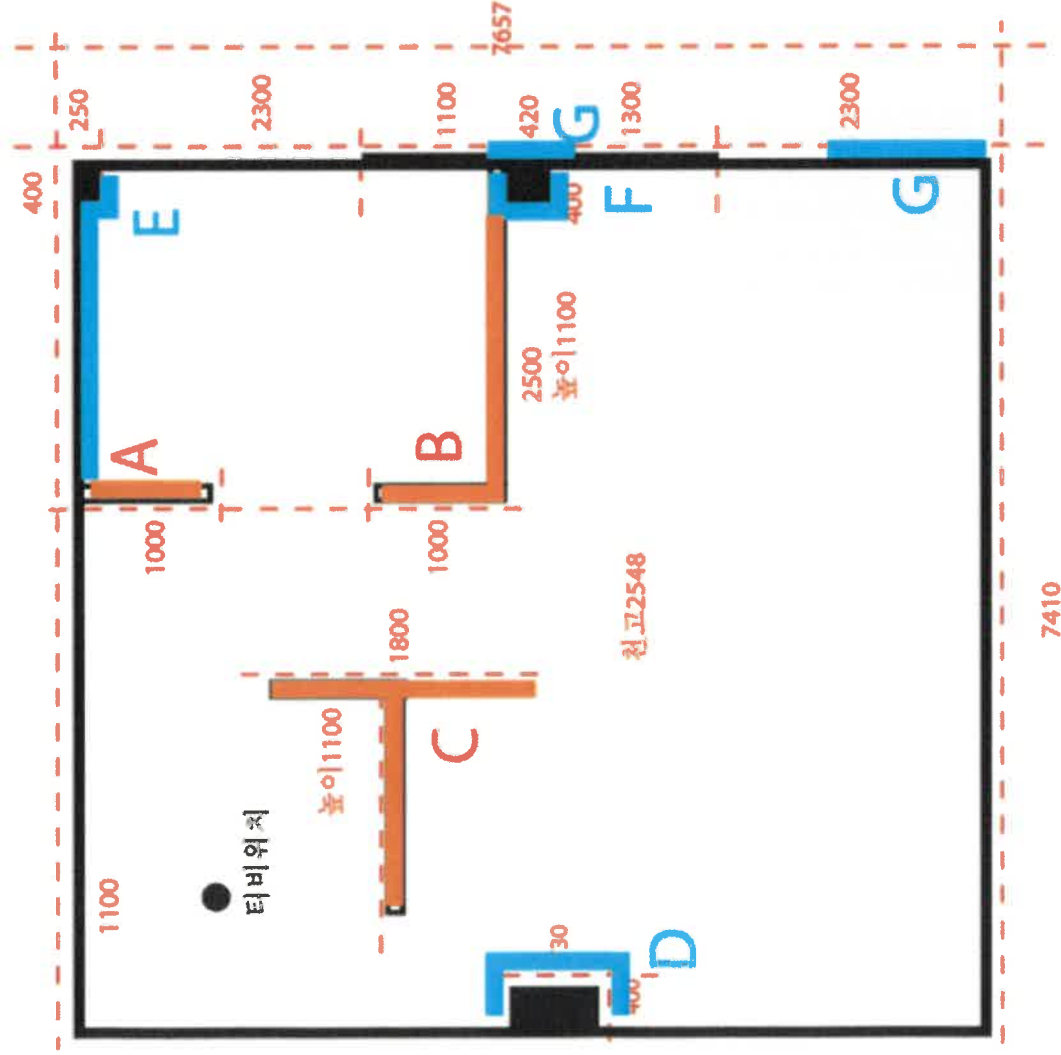

교실 칸막이 양면 템바루바

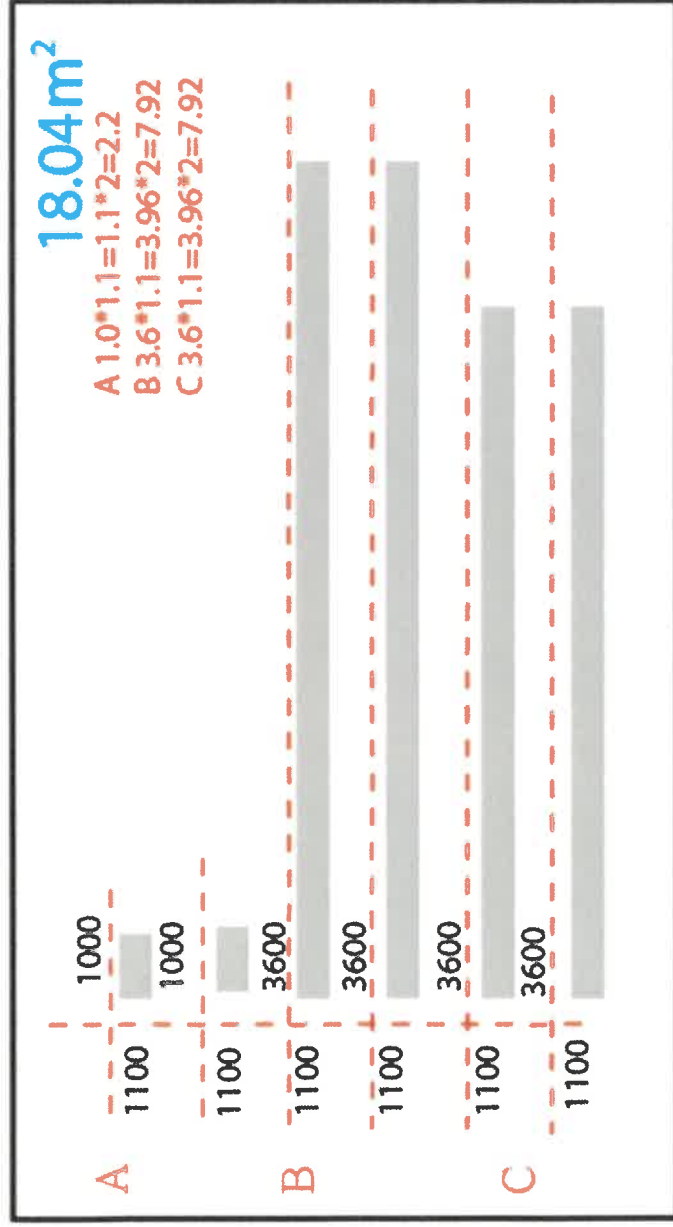

교실 벽체 템바루바

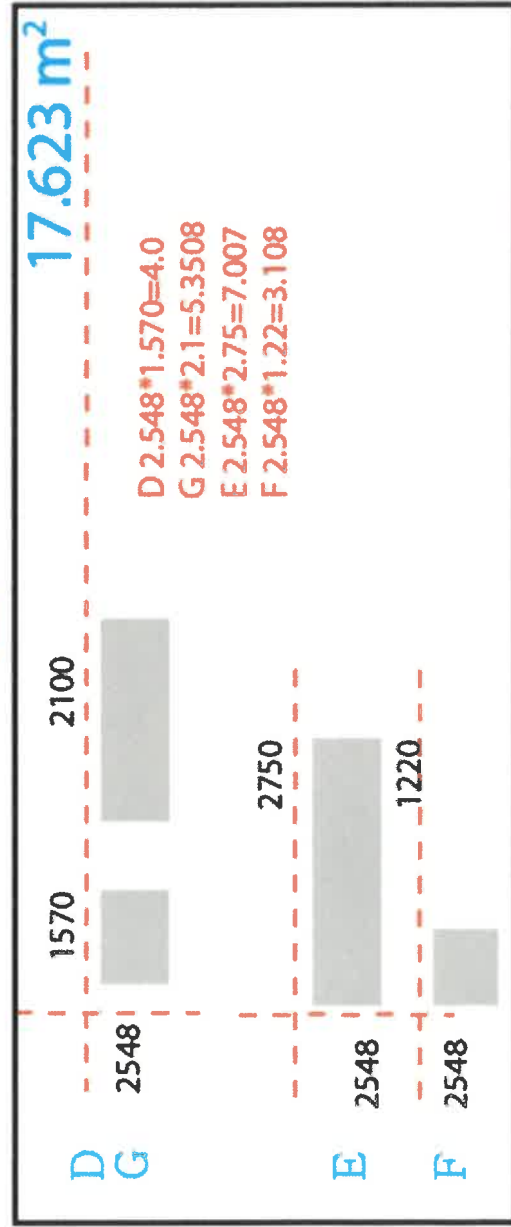

상부 물딩

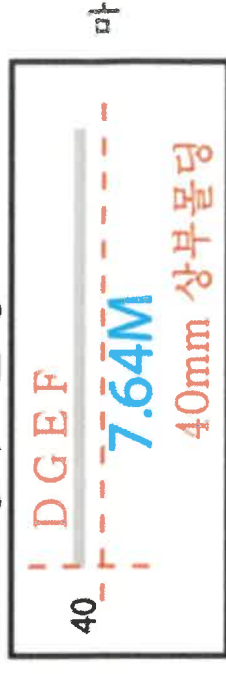

하부 물딩



내부 친환경 페인트

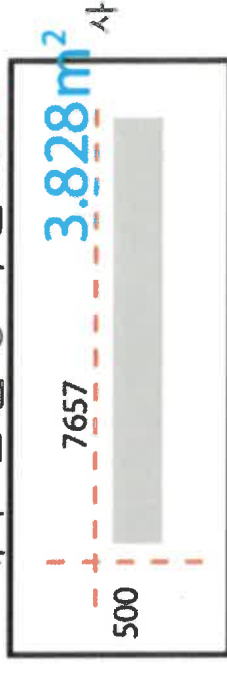

타일 붙임



1. 9T방염 백색 템바루바 붙임 마감
2. 9T방염 백색 템바루바 붙임 마감
3. 40mm9T 상부물딩
4. 90mm9T 걸레받이 물딩
5. 내부친환경페인트
6. 테라조롱타일 500mm